

TOKU 



CONSTRUCTION & INDUSTRIAL TOOLS

Ver 2.02

TOKU PNEUMATIC CO., LTD.
www.toku-net.co.jp/en

RIVET BUSTERS

B FEATURES

- Offering 3 type models (7" 9" 11") for optimum job selection.
- Both inside and outside trigger handle are available.
- High technology for best power-to-weight ratio
- Feather touch trigger control helps precise job operation.

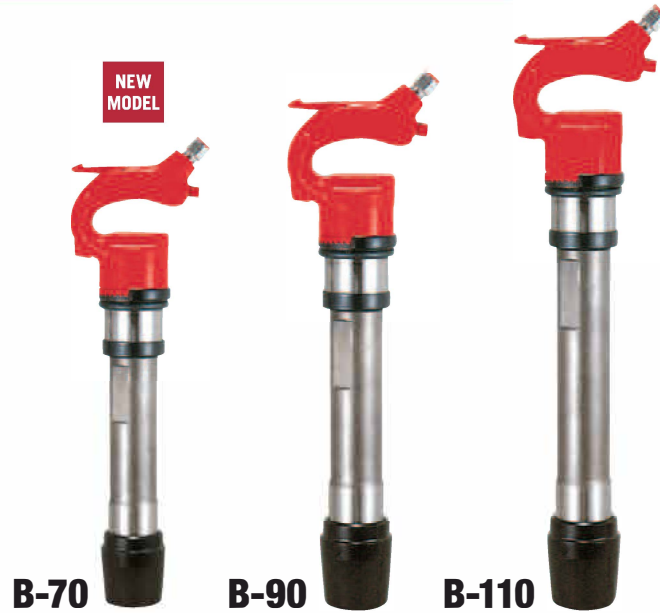

INSIDE TRIGGER TYPE

B-70 I
B-90 I
B-110 I

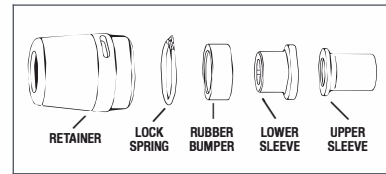

CLAY DIGGERS

TCD FEATURES

- Heat-treated forged body for excellent durability.
- Noise reduction muffler is optionally available.
- D-style handle for precise control and safe use
- Latch retainer for quick change

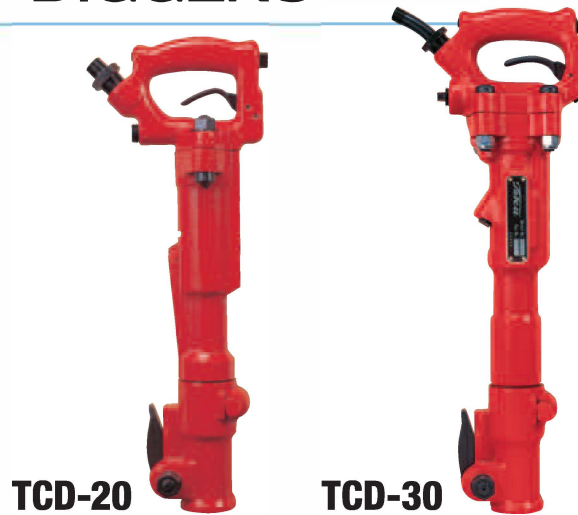

OPTIONAL MUFFLER



TCD-20



TCD-30

SPECIFICATION

| MODEL | CHUCK SIZE inch | STROKE inch (mm) | BORE inch (mm) | IMPACT RATE B.P.M. | WEIGHT lb (kg) | LENGTH inch (mm) | AIR CONSUMPTION CFM (m ³ /min) | AIR INLET inch | HOSE SIZE inch (mm) |
|--------|----------------------|---------------------|-------------------|-----------------------|-------------------|---------------------|--|-------------------|------------------------|
| B-70 | 1-1/2 or 1-7/32 | 7-3/8(188) | 1-3/16(30.2) | 940 | 28(12.9) | 19-3/4(500) | 37(1.05) | 3/8 PT | 3/4(19) |
| B-90 | 1-1/2 | 9(227) | 1-3/16(30.2) | 700 | 32(14.5) | 23(582) | 36(1.02) | 3/8 PT | 3/4(19) |
| B-110 | 1-1/2 | 12(303) | 1-3/16(30.2) | 680 | 34(15.7) | 26(660) | 33(1) | 3/8 PT | 3/4(19) |
| TCD-20 | 7/8x3-1/4 | 2-3/8(60) | 1-11/16(42.85) | 2,000 | 22(10) | 20(520) | 38(1.1) | 1/2 NPT | 1/2(12.7) |
| TCD-30 | 7/8x3-1/4 or 1x4-1/4 | 3-11/32(85) | 1-3/4(44.45) | 1,550 | 30(13.6) | 22(559) | 49(1.4) | 3/8 PT | 1/2(12.7) |

Dynamic pressure: 90 PSI (0.6MPa) for all products